

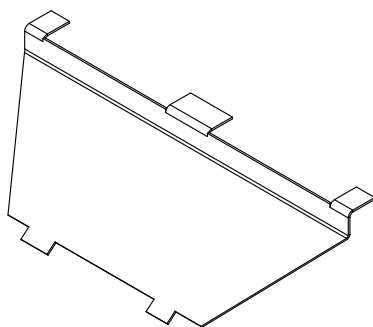

REMOVAL AND INSTALLATION OF KOZI MODEL 100/KSH 120 HEAT SHIELDS

THE INTERIOR HEAT SHIELDS INCLUDE:



TOP HEAT SHIELD

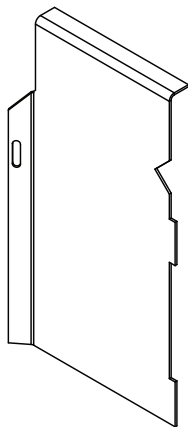

LEFT SIDE
HEAT SHIELD

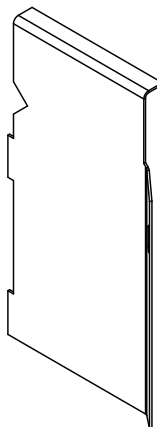

RIGHT SIDE
HEAT SHIELD

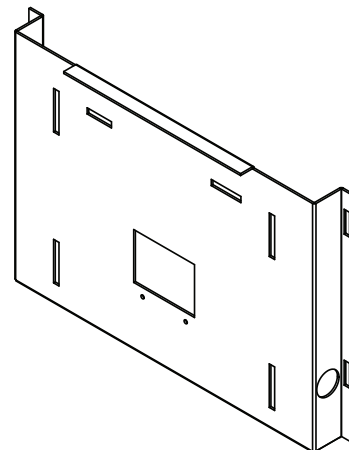

BACK HEAT SHIELD

TOOLS REQUIRED:

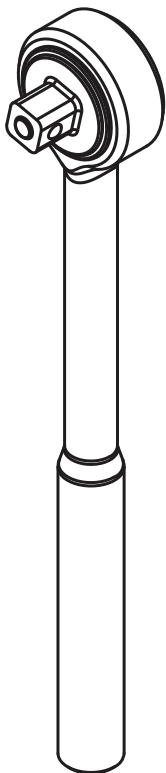

SOCKET WRENCH

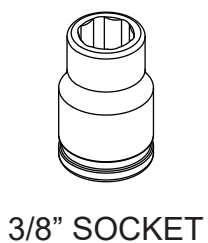

3/8" SOCKET



1 OPEN FRONT DOOR AND REMOVE THE
BURN POT STAND ASSEMBLY FROM THE
STOVE.

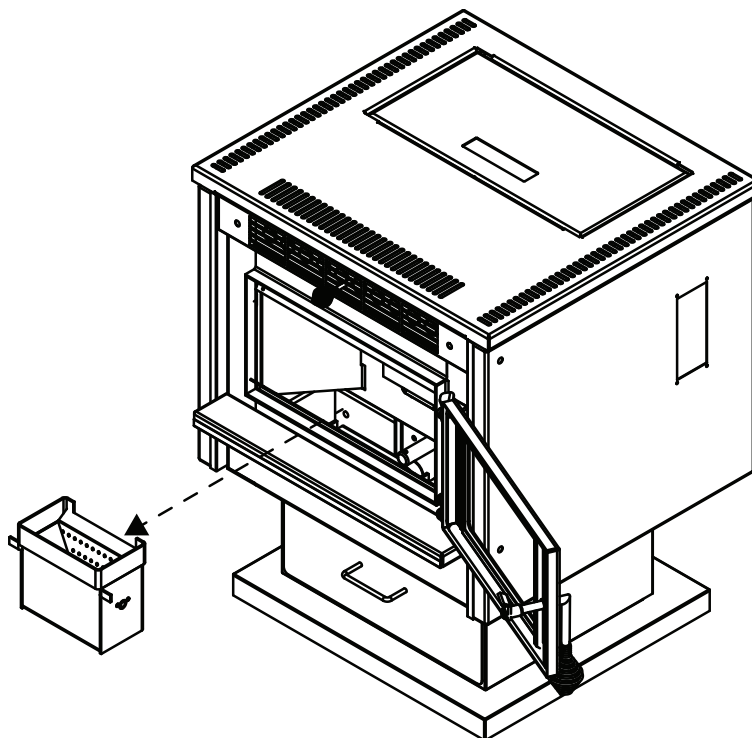

2

PUSH TOP HEAT SHIELD UP, AND THEN PULL THE TOP HEAT SHIELD OUT OF THE STOVE AS SHOWN BELOW.

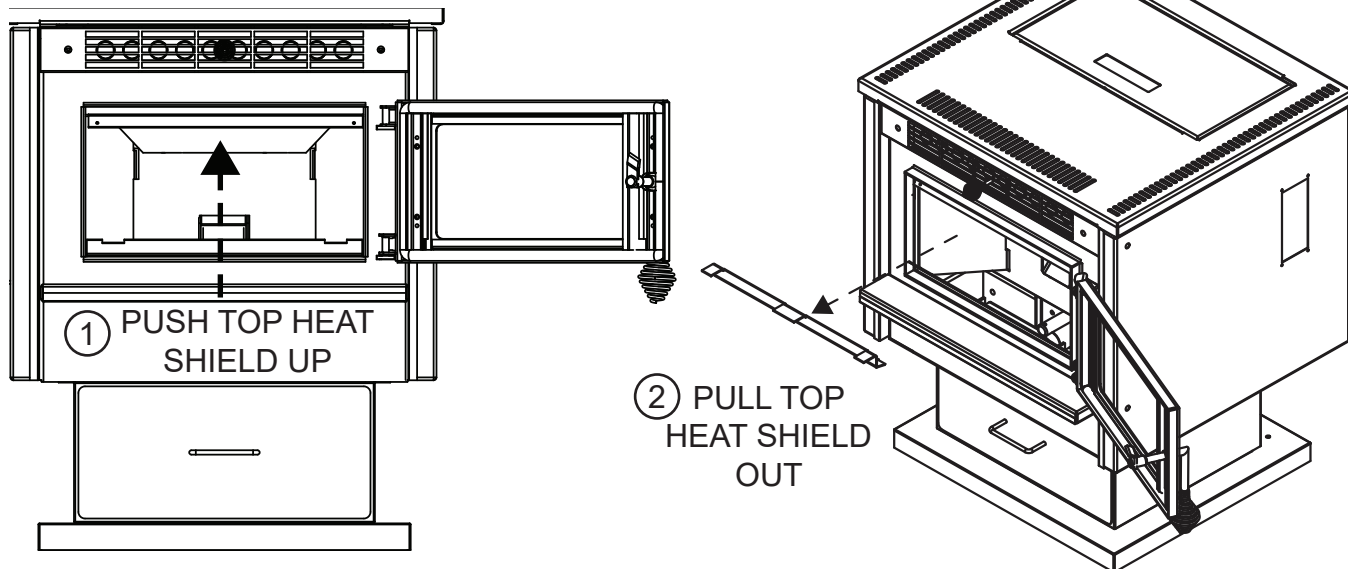

3

REMOVE THE BOLTS HOLDING THE SIDE HEAT SHIELDS IN PLACE USING A 3/8" SOCKET AND SOCKET WRENCH AS SHOWN BELOW.

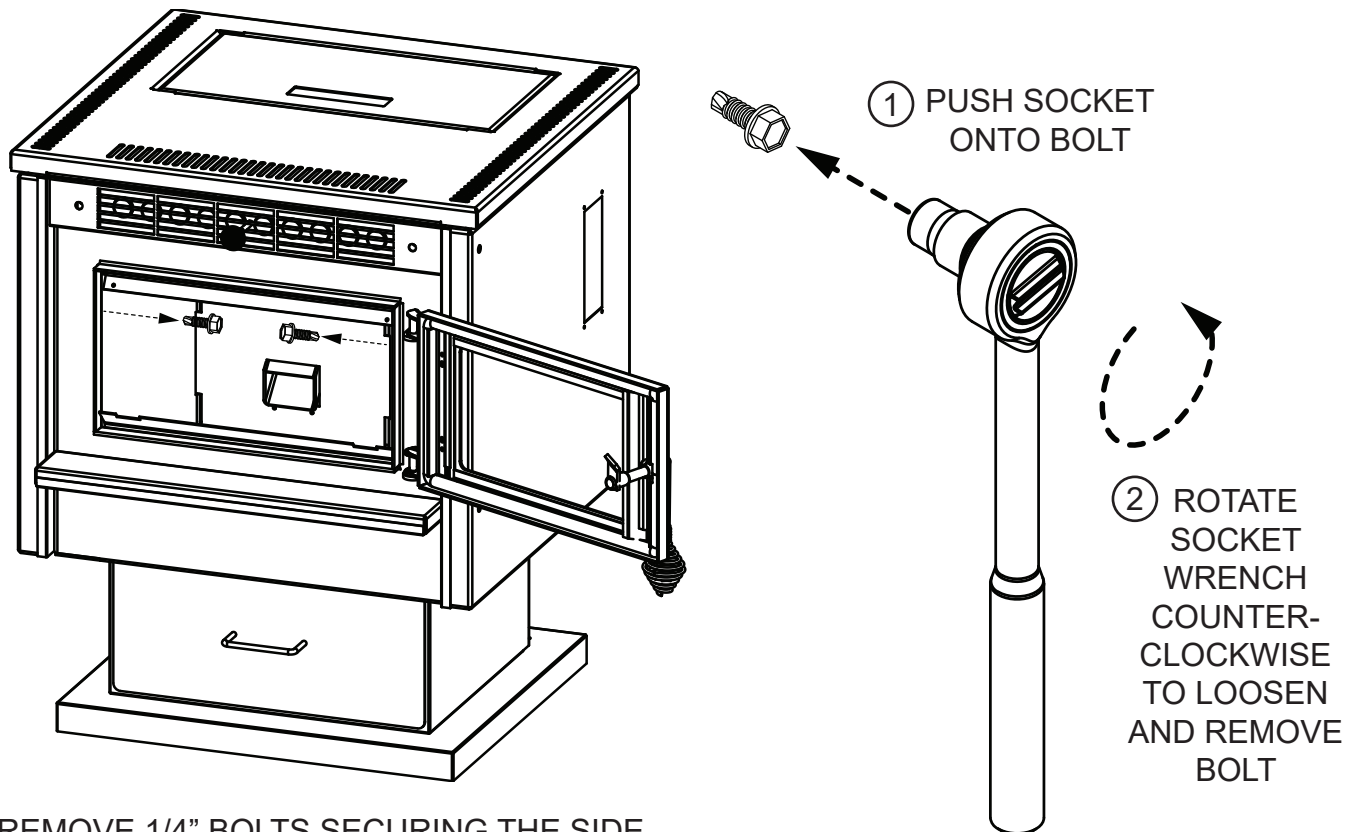

REMOVE 1/4" BOLTS SECURING THE SIDE HEAT SHIELDS TO THE STOVE USING YOUR SOCKET AND SOCKET WRENCH

4

ONCE THE BOLTS HAVE BEEN REMOVED, YOU WILL BE ABLE TO PULL THE SIDE HEAT SHIELDS OUT.

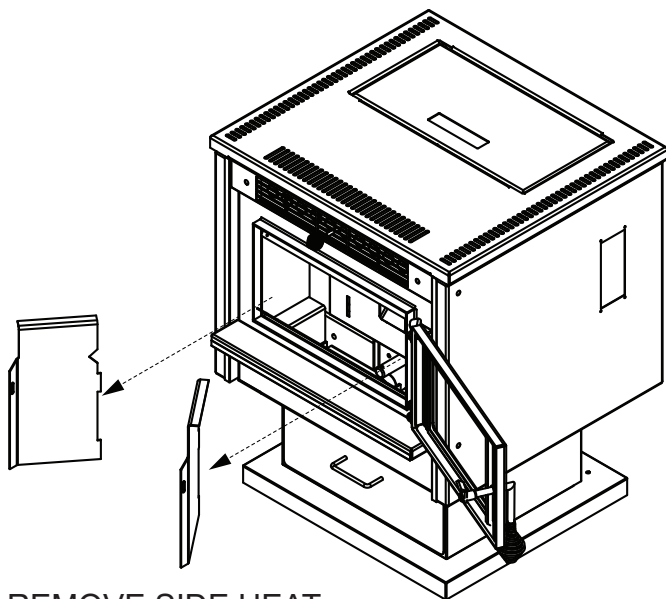

REMOVE SIDE HEAT SHIELDS FROM BURN CHAMBER.

6

PULL THE BACK HEAT SHIELD OUT SLOWLY. REMOVE AUGER CHUTE GASKETS TO INSPECT (REPLACE IF NEEDED).

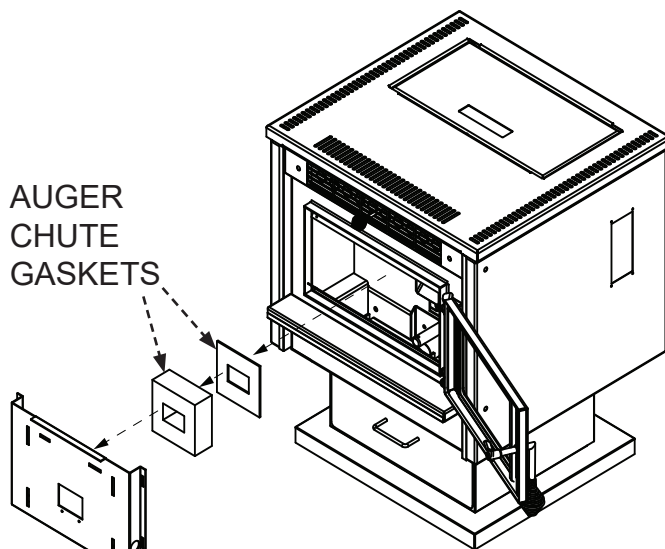

AUGER CHUTE GASKETS

BACK HEAT SHIELD

5

USING THE SOCKET AND SOCKET WRENCH, REMOVE THE 4 BOLTS SECURING THE BACK HEAT SHIELD TO THE BACK WALL OF THE BURN CHAMBER.

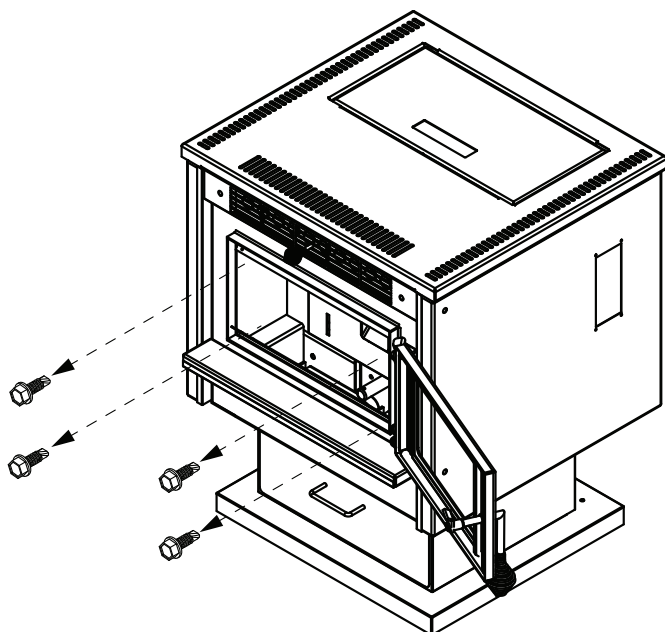

REMOVE 1/4" BOLTS SECURING THE BACK HEAT SHIELD TO THE STOVE USING YOUR SOCKET AND SOCKET WRENCH

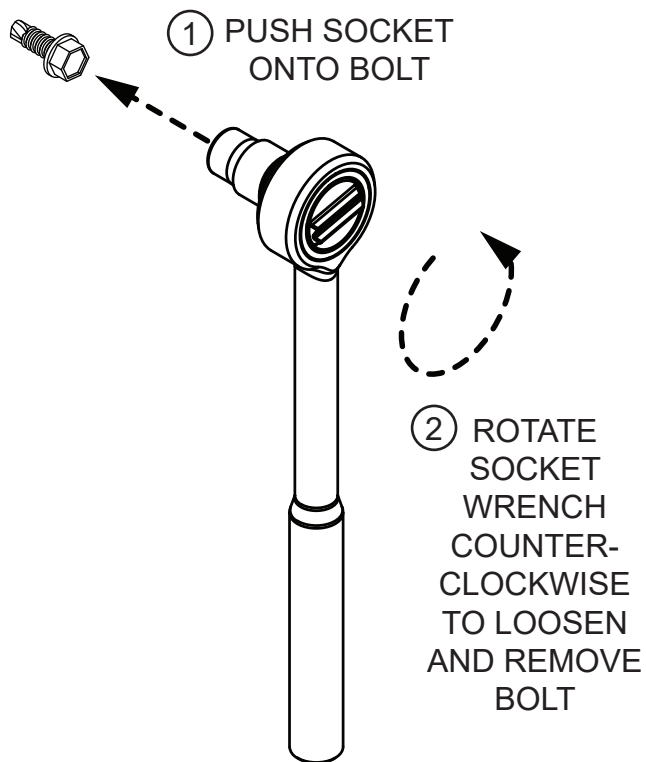

7

PUT THE AUGER CHUTE GASKETS AND NEW BACK HEAT SHIELD AS SHOWN BELOW. ENSURE THE AUGER CHUTE GASKETS ARE INSTALLED CORRECTLY TO PREVENT AIRFLOW PROBLEMS.

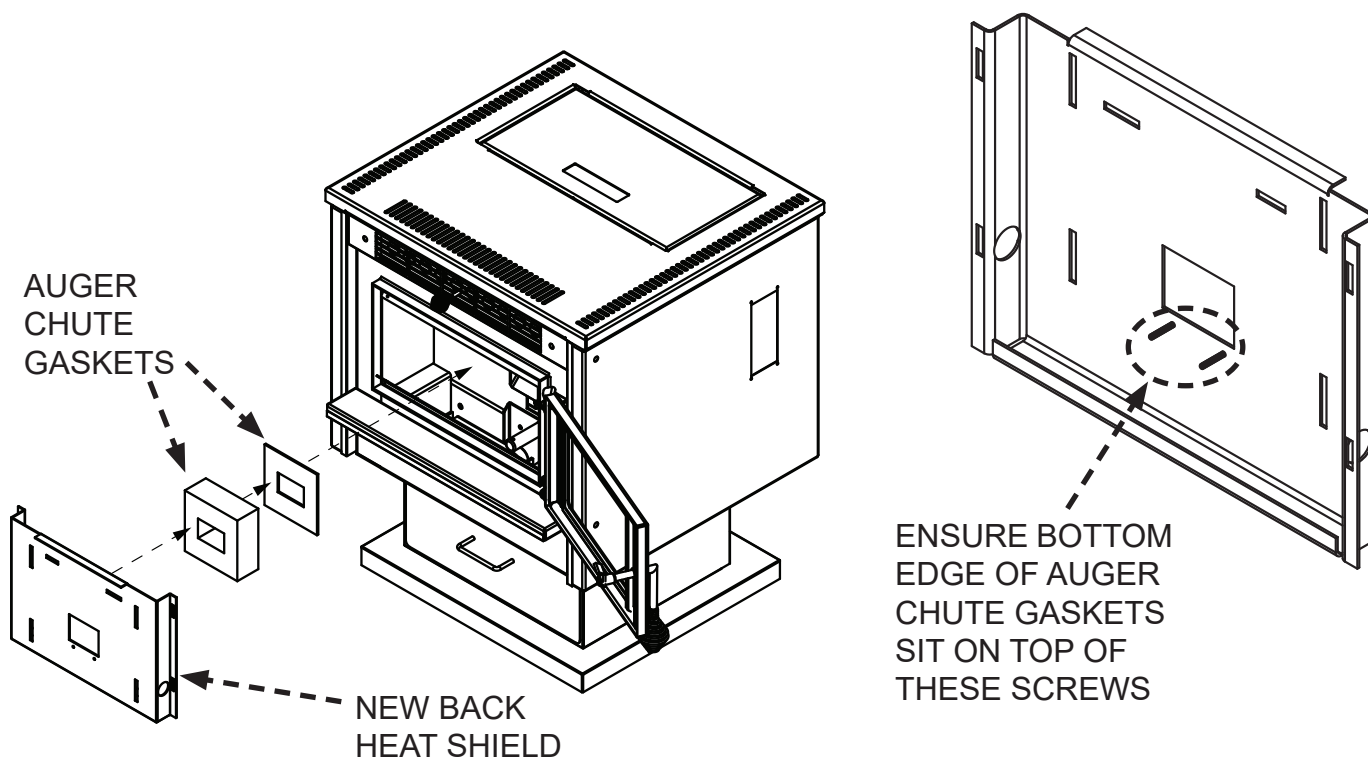

8

SECURE THE BACK HEAT SHIELD, USING THE SOCKET AND SOCKET WRENCH, AS SHOWN BELOW.

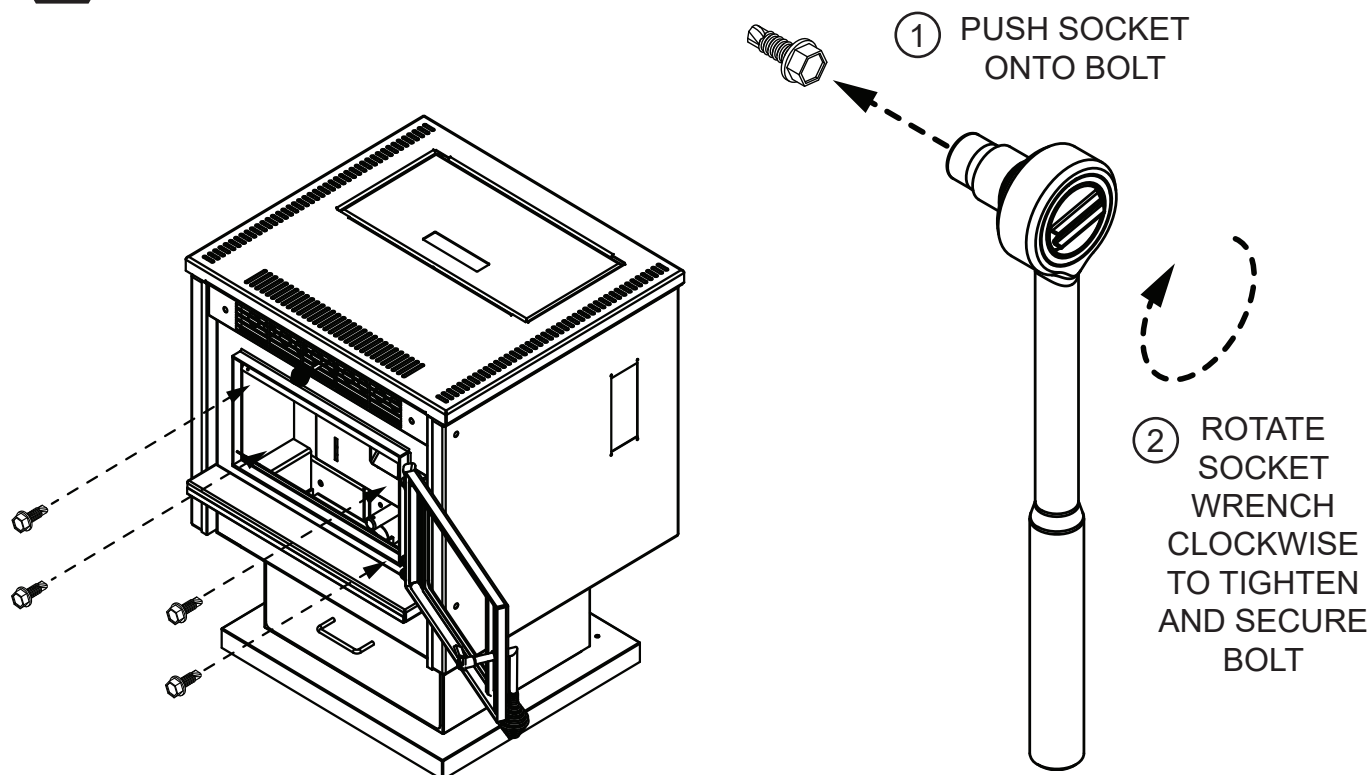

9

PUT NEW SIDE HEAT SHIELDS IN THE CORRECT POSITION IN THE BURN CHAMBER

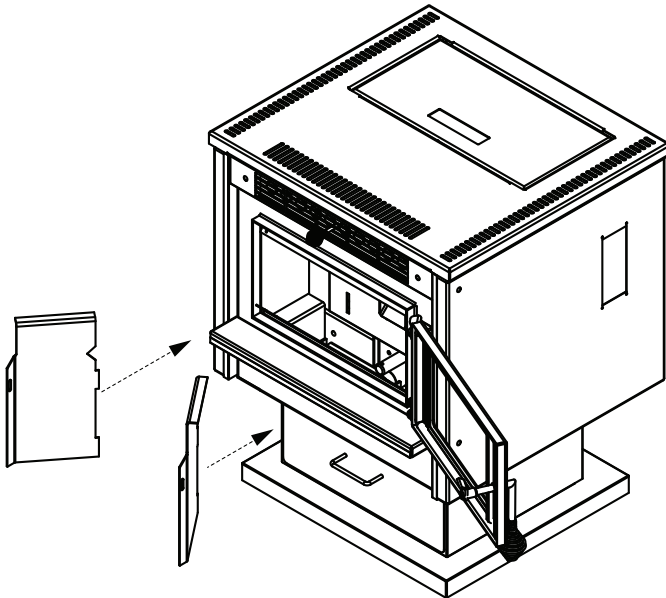

PLACE NEW SIDE HEAT SHIELDS INTO BURN CHAMBER

11

PUT THE TOP HEAT SHIELD BACK IN PLACE AS SHOWN.

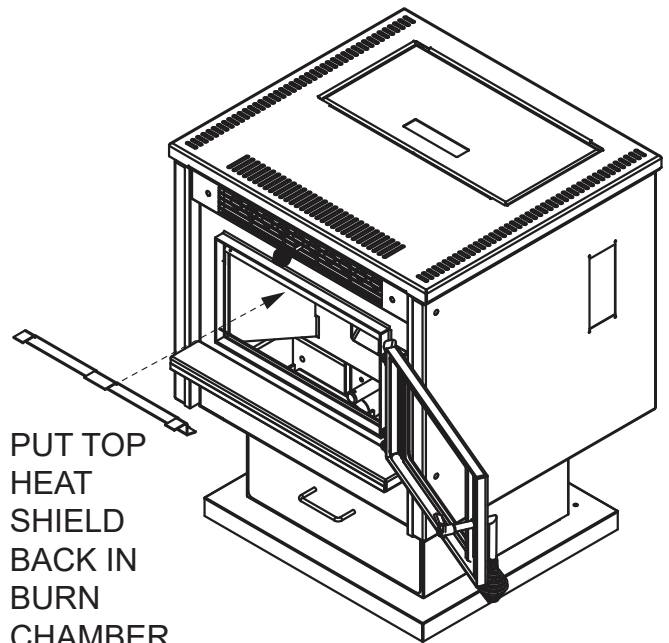

10

SECURE THE SIDE HEAT SHIELDS IN PLACE WITH BOLTS AS SHOWN BELOW.

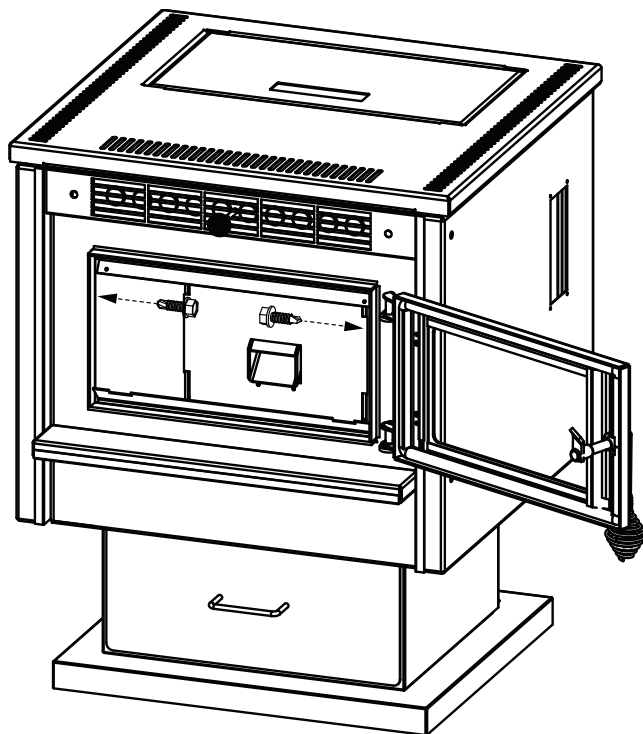

SECURE THE 1/4" BOLTS USING YOUR SOCKET AND SOCKET WRENCH TO HOLD THE SIDE HEAT SHIELDS IN PLACE

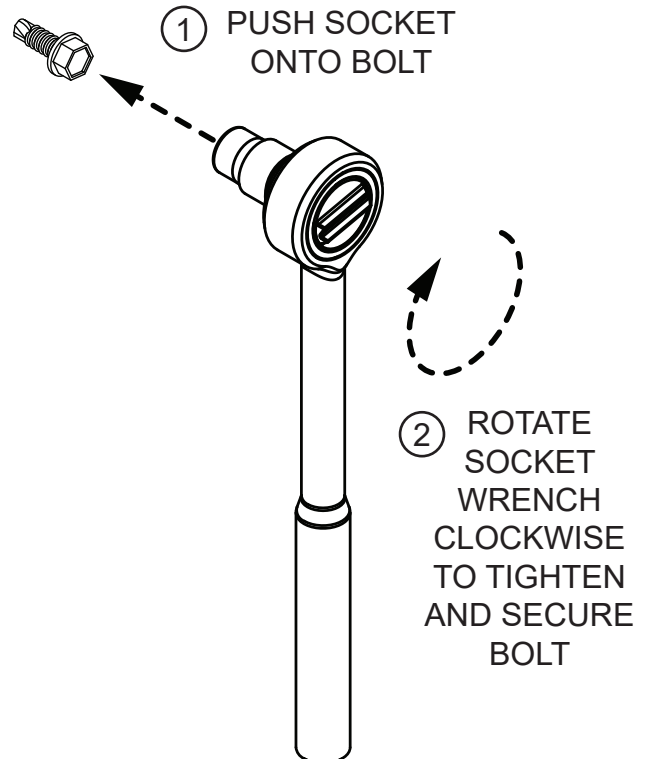

12

ENSURE TO INSTALL THE TOP HEAT SHIELD CORRECTLY. INSTALLING THE TOP HEAT SHIELD INCORRECTLY MAY CAUSE DAMAGE TO THE STOVE AS WELL AS DANGEROUS OPERATION CONDITIONS.

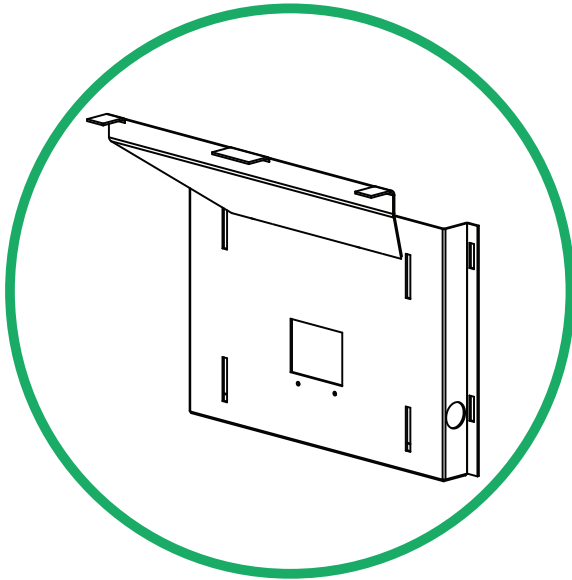

CORRECT

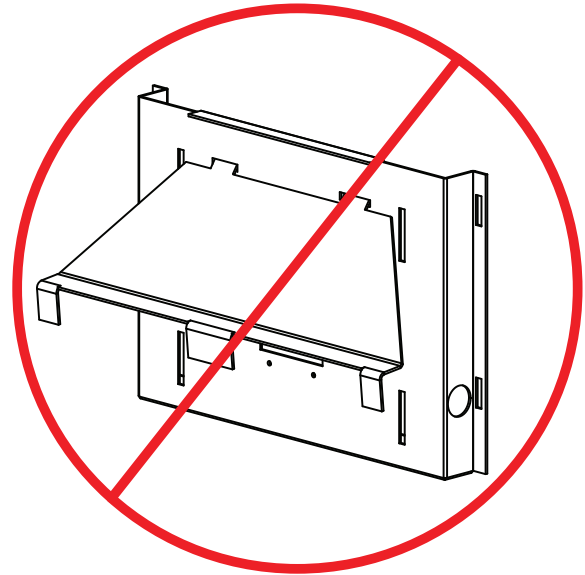

INCORRECT

13

PUT THE BURN POT ASSEMBLY BACK INTO THE STOVE. ENSURE THAT THE BURN POT AND BURN POT STAND ARE CLEAN AND FREE OF ASH OR ANY OTHER DEBRIS.

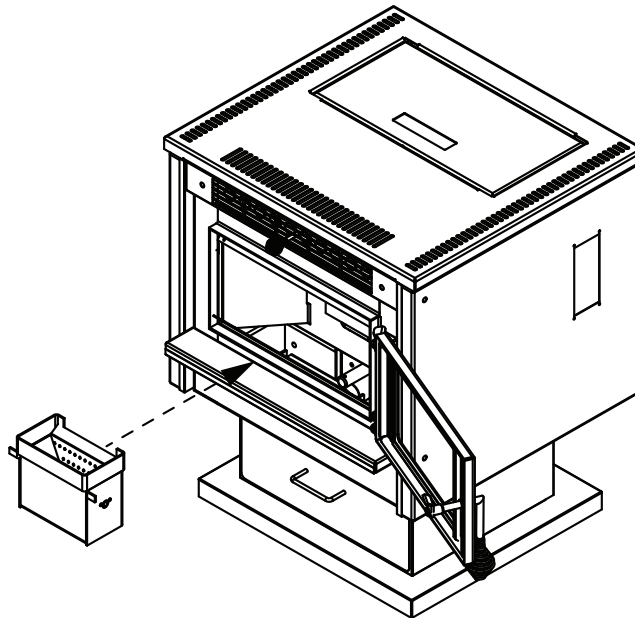

KOZI (Division of APR Industries Ltd.)

1354 Waverley Street, Winnipeg, Manitoba, Canada, R3T 0P5

Phone: (204) 452-9907, Fax: (204) 453-2747

Email: mail@kozistoves.com, Website: www.kozistoves.com